

EL[®]MARK

The Brand of Electricity

LED CEILING LAMP DONUT



TECHNICAL SPECIFICATION

INDOOR- LED FIXTURES

ELMARK[®]

The Brand of Electricity

Technical data:

- Rated voltage: 230V; 50-60Hz
- Power: 20W; 32W
- Colour temp.: 4000K
- Power Supply: control gear, DC device-driver
- Light source: Nationstar SMD 2835
- Colour rendering index: Ra≥80
- Average Lifetime: 30 000h
- Beam angle: 120°
- Body: Metal+ MS
- Colour of the body: White
- Installation: Surface mounting
- Protection against dust and moisture: IP20

Features:

- Energy saving, low power consumption, high efficiency.
- Environmentally friendly - no mercury and lead. No ultraviolet and infrared rays
- Excellent CRI
- Repeated switch on/off does not affect the lifespan
- Safety, low voltage operation
- Instant light with maximum luminous flux
- Simple appearance, suitable for a variety of household styles
- Widely used at shopping malls, meeting-rooms, hotel, residential, office, households etc..

Variants and Dimensions:

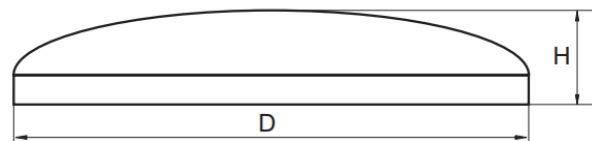

Watt (W)	Whole fixture lumens (lm)	Colour temp. (K)	Colour body	Size (mm)		Packing/ Box (pcs)	Catalogue number
				Diameter	Height		
20	1300	4000	white	285	80	1	95DONUT20LED
32	2000	4000	white	385	95	1	95DONUT32LED

TECHNICAL SPECIFICATION

INDOOR- LED FIXTURES

ELMARK[®]

The Brand of Electricity



ELMARK
lighting

95DONUT20LED



This luminaire contains built-in LED lamps.

A ⁺⁺	}	L E D
A ⁺		
A		
B		
C		
D		
E		

The lamps cannot be changed in the luminaire.

874/2012



EN 55015 • EN 61000-3-2 • EN 61000-3-3 • EN 61547 • EN 60598-1 • EN 60598-2-2 • EN 61347-1 • EN 61347-2-13 • EN 13032-4

